

Move from Undivided Share to
Undivided Happiness.



High Class
Amenities with
10,500 Sq. Ft.
CLUB HOUSE

Visit our model
VILLAS

CONSTRUCTION
in full swing

100% VAASTU
Compliance





Poomalai Housing Pvt. Ltd. is an established real estate company based out of Chennai. Since its inception in 1999, Poomalai Housing Pvt. Ltd. has come a long way in the last 15 years with over 50 projects under its belt and over 4,61,496 sq. ft. of built up living spaces. With a dynamic team of architects and engineers, the company has committed itself to delivering homes of the highest quality exceeding the expectations of the consumer time and again. Consistent quality of the highest order, timely deliveries, transparent and truthful business practices and affordable pricing have all come together to create a solid reputation among the customer base in and around Chennai.

V. Murugan

Chairman & Managing Director
Poomalai Housing

Dear valuable customers,

Greetings from Poomalai Housing!

I was looking for wide land within the city limit with naturally cool breeze, tasty ground water and surrounded with full greenery to execute my dream project. Finally I got my right location with all the right specifications spread over 5.70 acres at Kolapakkam in Porur.

'The Wind' – is not only the right name for my dream project but also the right price for the luxury Villa and land. Yes, the land that your villa is built on completely belongs to you. Which means that as the years go by it's not just the happy memory that grows in your home, but also your investment. The Wind with 142 individual luxury villas and town houses.

I am very happy to bring to you this dream project and offering it to you at a competitive price when compared with other projects in the same location. "The Wind" is another stone adding to the crown of Poomalai Housing.

Regards

(V. Murugan)









Happiness is an investment that multiplies over time.

Introducing The Wind from Poomalai Housing. With 140 individual Luxury Villas and Town Houses spread over 5.70 acres of prime property at Kolapakkam near Porur, here you will find all the space you need to lead the life you always aspired to. What's more, here the land that your home is built on completely belongs to you. Which means that as the years go by, it's not just the happy memories that grow in your home, but also your investment. Because a home is an asset that is passed down generations.



Breezy homes. For a breezier life.

While most people talk about well ventilated homes, we have actually gone ahead and given you exactly that. Villas at The Wind stay true to the name. In that, they are not only luxurious and spacious, they are built right from the design stage to maximise your living area and give you ample ventilation.

Ranging from 1200 sq.ft. to 3000 sq.ft. here you will find all the space you need to live the life you desire. With enough distance between the Villas, your own private courtyard, large windows and larger balconies, let your home bask in the glory of natural light. And let the cool breeze serenade you.

Just elevation of every Villa is on a class of its own. Contemporary and offbeat, these designs make your home stand out of the clutter and elevate your lifestyle. And on the inside, we have bathed your home in luxury. Even the smallest of fixtures at your home are of the highest specification. All of it, just to give you a lifestyle that you deserve to lead.

140
LUXURY VILLAS
& TOWN HOUSES

5.70
ACRES

RANGING FROM
1200
TO
3000
Sq. Ft.

LOCATION MAP

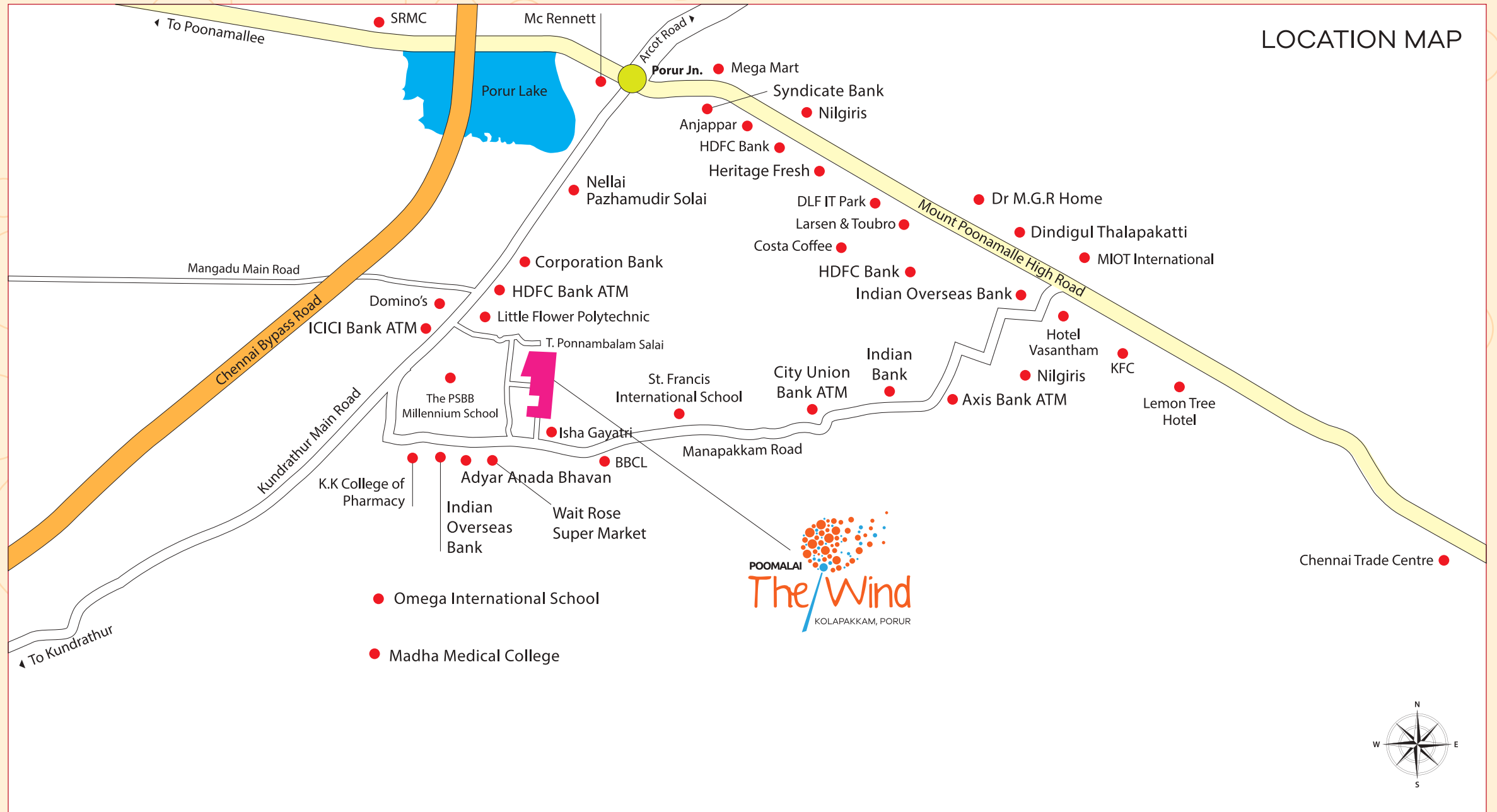

A convenient location for a brighter tomorrow.

The Wind is built on a sprawling 5.70 acres of prime land at Kolapakkam in Porur - a locality that is increasingly becoming one of the most sought after residential hubs in Chennai. Located just 3.5 kms from Porur Junction, here you will be close to some of the biggest MNCs, top educational institutions and world class healthcare providers. Add to this the rapid development taking place in the locality, real estate prices are set to sky rocket in the near future. Which means, you not only get to live in a state of the art home, it is also an investment that is set to multiply as the years go by.



Location Advantages:

Kundratur Main Road.....	0.8 Kms
Porur Junction.....	3.5 Kms
Mangadu Sri Kamakshi Temple.....	5.5 Kms
Airport.....	7.8 Kms
Railway Station,Guindy.....	9.5 Kms
Medical Facilities	
SRMC.....	5.0 Kms
MIOT.....	7.0 Kms
Apollo Speciality Hospital, Vanagaram.....	8.0 Kms
Restaurants	
Adyar Ananda Bhavan.....	0.2 Kms
Dominos.....	1.5 Kms
Lemon Tree.....	4.0 Kms
KFC.....	4.0 kms
Anjappar.....	4.0 kms
Dindigul Thalapakatti.....	4.5 Kms
Sangeetha Veg Restaurant.....	6.8 Kms
Educational Institutions	
PSBB Milenium School.....	0.5 Kms
St.Francis International School.....	0.8 Kms
Omega International School.....	1.0 Km
K.K. College of Pharmacy.....	1.3 Kms
Madha Medical College.....	4.0 Kms
Sri Krishna International School.....	4.5 Kms
SRM Dental College.....	5.0 Kms
Muthu Kumaran College of Medical.....	5.2 Kms
Anna University.....	13 Kms
I.I.T., Chennai.....	13 Kms
Commercial	
HP.....	3.3 Kms
DLF IT Park.....	5.0 Kms
L&T.....	6.0 Kms
Nandambakkam Trade Center.....	6.4 Kms
Financial Institutions	
Indian Overseas Bank.....	0.4 Kms
ICICI Bank.....	1.5 Kms
CUB ATM.....	1.8 Kms
HDFC Bank.....	2.0 Kms
Indian Bank.....	2.5 Kms
Super Markets	
White Rose Super Market.....	0.4 Kms
Nellai Pazhamudhir Solai.....	2.5 Kms
Mega Mart.....	3.5 Kms
Nilgiris.....	4.0 Kms



PHASE - 1
PHASE - 2

MASTER LAYOUT

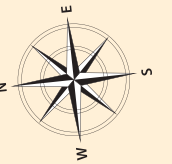

Amenities



By living at The Wind you can actually measure happiness, because we offer you top notch amenities with an edge of urban sophistication. A good combination of modern and uncompromised amenities in plenty, takes your life to its splendid best. Furthermore, your experience at The Wind changes the very quantum of luxury as we know it.

Safety first, live a carefree life

- CCTV Surveillance system
- Video door phone from Honeywell
- Security personnel at the Main entrance



- Swimming Pool (Size: 40 X 18 ft)
- Poolside deck and change over rooms
- Mini Theater with 50 seating
- Party Roof Garden in Club House
- Multi-Purpose Hall with 100 seating
- Equipped modern gymnasium
- Indoor Games - Table Tennis & Pool Table
- Children's Play Area
- Fully landscaped OSR Park
- Creatively landscaped garden
- STP
- WTP
- Rain Water Harvesting
- Hydro Pneumatic Water Supply System
- Concrete / Paved roads with street lights
- Separate restroom for domestic staff and drivers in Club House
- Covered Car Park
- Power Back-up in Club House
- Jogging Track



Specifications



- Structure** : Ground + two levels RCC structure, covered car park in ground floor
- Plastering** : Internal & Ceiling: 12 mm thick double coat cement plaster with smooth finish. External: 18 mm thick double coat cement plaster
- Flooring** : 2' X 2' Vitrified Tile flooring for all rooms
- Kitchen** : Granite polished edge counter top, Stainless steel sink, Designer ceramic tiles two feet above counter, Superior quality anti-skid ceramic tiles on utility area
- Staircase** : Internal staircase. Granite raiser and S.S railing
- Toilet** : Designer ceramic tiles upto door height, Hindware brand sanitary ware, Hindware brand CP fittings and 'ISI' brand plumbing accessories, Superior quality anti-skid ceramic tiles on floor
- Balconies** : Superior quality anti-skid ceramic tiles floor & S.S railing
- Terrace** : Superior quality weatherproof tiles flooring
- Main Door** : Designer Main Door
- Doors** : Laminate finish on both side designed flush doors
- Windows** : UPVC with clear plain glass

- Painting** : Internal walls: Superior wall putty with acrylic emulsion paint, External walls: Plaster finish with weather shield exterior emulsion
- Electrical** : Concealed copper wiring using Havells cables or equivalent, 5/15 Amps points with touch switches
- Power** : Three phase power supply
Stand-by power source for club house, water pumps & common lights only
- Water** : Hydro Pneumatic System with treated water, Separate Municipal water supply in Kitchens
Provision for geysers in all bathrooms
Rain water harvesting pits for water conservation
- Air conditioning** : Provision for split A/C ducting in all bedrooms and living room
- DTH** : Provision for DTH TV Point in all bedrooms and living room
- Telephone/ Internet** : Provision for telephone point/internet in all bedrooms, living room and dining room



Payment Schedule:

On Booking	:	Rs. 5 Lakhs
At the time of registration	:	40%
At the time of foundation	:	20%
At the time of brick work	:	20%
At the time of plastering	:	15%
On key handing over	:	5%

CLUB HOUSE



CLUB HOUSE

Build Up Area: 10,500 Sq.Ft.

Land Area: 4749 Sq.Ft.

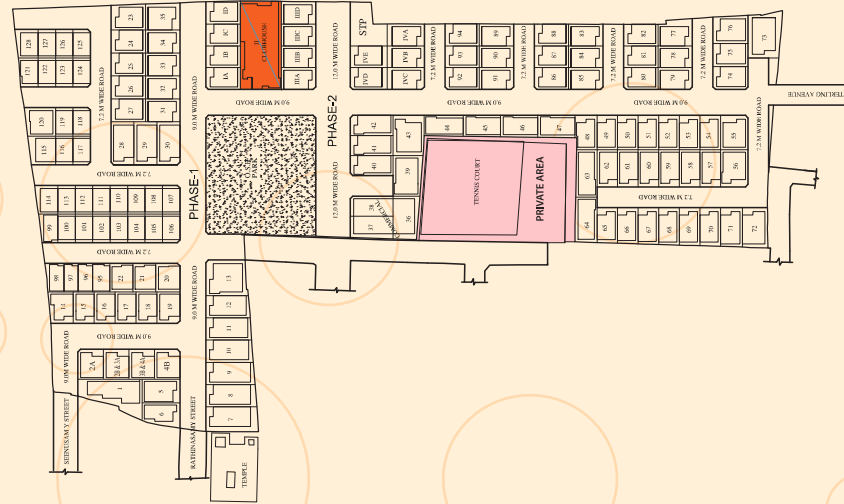

Ground Floor



First Floor

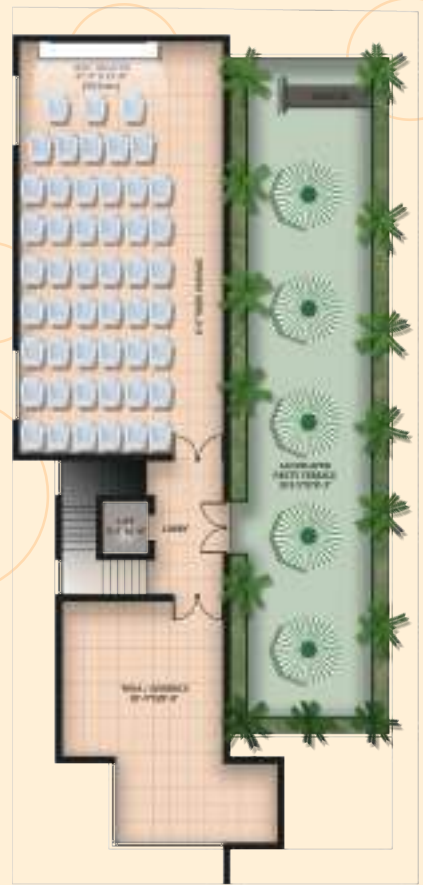

Second Floor

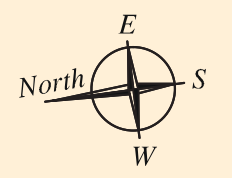

THE WIND @ KOLAPAKKAM - AREA STATEMENT

PLOT No.	PATTERN	TYPE	FACING	No. OF BED	LAND AREA IN SQ. FT.	SALABLE AREA IN SQ. FT. (INCLUDE CLUB HOUSE)
1	Villa	A	NORTH	4+2	2352	3791
2A	Villa	B	EAST	4	984	2018
2B&3A	Villa	B	EAST	4	984	2018
3B&4A	Villa	B	EAST	4	984	2018
4B	Villa	B	EAST	4	984	2018
5	Villa	C	EAST	4	1276	2375
6	Villa	D	EAST	3	1026	1723
7	Villa	E	NORTH	4+1	1686	2647
8	Villa	E	NORTH	4+1	1467	2647
9	Villa	E	NORTH	4+1	1414	2647
10	Villa	E	NORTH	4+1	1362	2506
11	Villa	E	NORTH	4+1	1317	2458
12	Villa	E	NORTH	4+1	1270	2364
13	Villa	F	NORTH	4+2	1878	2977
14	Villa	G	NORTH	4	981	1747
15	Villa	G	NORTH	4	864	1621
16	Villa	G	NORTH	4	864	1621
17	Villa	G	NORTH	4	864	1614
18	Villa	G	NORTH	4	864	1621
19	Villa	G	NORTH	4	945	1800
20	Villa	G	EAST	3	911	1875
21	Villa	G	EAST	3	862	1828
22	Villa	G	EAST	3	862	1828
23	Villa	H	NORTH	4	1148	1885
24	Villa	H	NORTH	4	1037	1901
25	Villa	H	NORTH	4	1037	1912
26	Villa	H	NORTH	4	1037	1912
27	Villa	H	NORTH	4	1037	1912
28	Villa	I	NORTH	4+1	1293	2454
29	Villa	I	NORTH	4+1	1293	2454
30	Villa	I	NORTH	3+1	1293	2454
31	Villa	H	EAST	4	1037	1912
32	Villa	H	EAST	4	1037	1912
33	Villa	H	EAST	4	1037	1912
34	Villa	H	EAST	4	1037	1912
35	Villa	H	EAST	4	1205	2156
36	Commercial				1417	1837
37	Commercial					
38	Commercial				2369	3383
39	Villa	J	NORTH	4	1515	2875
40	Villa	K	NORTH	4+1	1133	2402

PLOT No.	PATTERN	TYPE	FACING	No. OF BED	LAND AREA IN SQ. FT.	SALABLE AREA IN SQ. FT. (INCLUDE CLUB HOUSE)
41	Villa	K	NORTH	4+1	1120	2402
42	Villa	K	NORTH	4+1	1145	2402
43	Villa	L	NORTH	4+1	1626	2788
44	Villa	M	NORTH	4+1	1048	2236
45	Villa	M	NORTH	4+1	1035	2106
46	Villa	M	NORTH	4+1	1060	2106
47	Villa	M	NORTH	4+1	1083	2106
48	Villa	G	EAST	4	969	1883
49	Villa	G	EAST	4	920	1883
50	Villa	G	EAST	4	930	1883
51	Villa	G	EAST	4	930	1883
52	Villa	G	EAST	4	930	1883
53	Villa	G	EAST	4	930	1883
54	Villa	G	EAST	4	930	1883
55	Villa	P	EAST	4+1	1240	2278
56	Villa	P	NORTH	4+1	1343	2328
57	Villa	G	NORTH	4	1007	1957
58	Villa	G	NORTH	4	1007	1957
59	Villa	G	NORTH	4	1007	1957
60	Villa	G	NORTH	4	1007	1957
61	Villa	G	NORTH	4	1007	1957
62	Villa	G	NORTH	4	996	1957
63	Villa	Q	NORTH	4	1299	2519
64	Villa	Q	EAST	4	1285	2244
65	Villa	G	EAST	4	945	1883
66	Villa	G	EAST	4	973	1883
67	Villa	G	EAST	4	993	1927
68	Villa	G	EAST	4	1010	1927
69	Villa	G	EAST	4	1026	1927
70	Villa	G	EAST	4	1043	2014
71	Villa	G	EAST	4	1122	2150
72	Villa	N	EAST	4	1324	2389
73	Villa	O	NORTH	4+1	1902	2501
74	Villa	H	NORTH	4	1052	2065
75	Villa	H	NORTH	4	1052	2065
76	Villa	H	NORTH	4	1259	2150
77	Villa	H	EAST	4	1141	1883
78	Villa	H	EAST	4	984	1988
79	Villa	H	EAST	4	984	1988
80	Villa	H	NORTH	4	984	1988

THE WIND @ KOLAPAKKAM - AREA STATEMENT

PLOT No.	PATTERN	TYPE	FACING	No. OF BED	LAND AREA IN SQ. FT.	SALABLE AREA IN SQ. FT. (INCLUDE CLUB HOUSE)
81	Villa	H	NORTH	4	984	1988
82	Villa	H	NORTH	4	974	1988
83	Villa	H	EAST	4	977	1988
84	Villa	H	EAST	4	984	1988
85	Villa	H	EAST	4	984	1988
86	Villa	H	NORTH	4	984	1988
87	Villa	H	NORTH	4	984	1988
88	Villa	H	NORTH	4	984	1988
89	Villa	H	EAST	4	987	1988
90	Villa	H	EAST	4	984	1988
91	Villa	H	EAST	4	984	1988
92	Villa	H	NORTH	4	984	1988
93	Villa	H	NORTH	4	984	1988
94	Villa	H	NORTH	4	988	1988
95	Town House	R	EAST	3	657	1363
96	Town House	S	EAST	2	538	1126
97	Town House	S	EAST	2	538	1126
98	Town House	S	EAST	2	650	1154
99	Town House	T	NORTH	2	655	1093
100	Town House	U	NORTH	3	657	1226
101	Town House	U	NORTH	3	657	1226
102	Town House	U	NORTH	3	657	1226
103	Town House	U	NORTH	3	657	1226
104	Town House	U	NORTH	3	657	1226
105	Town House	U	NORTH	3	657	1226
106	Town House	U	NORTH	3	657	1250
107	Town House	U	EAST	3	657	1250
108	Town House	U	EAST	3	657	1226
109	Town House	U	EAST	3	657	1226
110	Town House	U	EAST	3	657	1226
111	Town House	U	EAST	3	657	1226
112	Town House	U	EAST	3	657	1226
113	Town House	U	EAST	3	657	1226
114	Town House	U	EAST	3	801	1250
115	Villa	W	NORTH	3	955	1583
116	Town House	U	NORTH	3	657	1250
117	Town House	U	NORTH	3	657	1250
118	Town House	U	EAST	3	657	1250
119	Town House	U	EAST	3	657	1250
120	Villa	V	EAST	3+1	1115	1633

PLOT No.	PATTERN	TYPE	FACING	No. OF BED	LAND AREA IN SQ. FT.	SALABLE AREA IN SQ. FT. (INCLUDE CLUB HOUSE)
121	Town House	U	NORTH	3	682	1125
122	Town House	U	NORTH	3	657	1226
123	Town House	U	NORTH	3	657	1226
124	Town House	U	NORTH	3	657	1250
125	Town House	U	EAST	3	657	1250
126	Town House	U	EAST	3	657	1226
127	Town House	U	EAST	3	657	1226
128	Town House	U	EAST	3	780	1250
IA	villa	H	NORTH	4	988	1988
IB	villa	H	NORTH	4	988	1988
IC	villa	H	NORTH	4	988	1988
ID	villa	H	NORTH	4	1026	1988
II	Clubhouse		WEST		4749	
IIIA	villa	H	EAST	4	988	1988
IIIB	villa	H	EAST	4	988	1988
IIIC	villa	H	EAST	4	988	1988
IIID	villa	H	EAST	4	1017	1988
IVA	villa	H	EAST	4	1063	2034
IVB	villa	H	EAST	4	1063	2034
IVC	villa	H	EAST	4	1063	2034
IVD	villa	H	NORTH	4	1063	2034
IVE	villa	H	NORTH	4	1063	2034

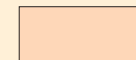

PHASE - 1

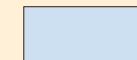

PHASE - 2



Successfully Completed Projects:

- ❧ Poomalai 'Vignesh', Thiruvanmiyur
- ❧ Poomalai 'Rani', Saidapet
- ❧ Poomalai 'Nadhi', Perungudi
- ❧ Poomalai 'Somu', Thiruvanmiyur
- ❧ Poomalai 'Arunachala', Pammal
- ❧ Poomalai 'Saravana', Pammal
- ❧ Poomalai 'Swamy Nivas', Thiruvanmiyur
- ❧ Poomalai 'Sree Ganेशa', Thoraipakkam, OMR
- ❧ Poomalai 'Sree Kumaran', Thoraipakkam, OMR
- ❧ Poomalai 'Sree Conarc', Palavakkam
- ❧ Poomalai 'Sree Velavan Nivas', Thiruvanmiyur
- ❧ Poomalai 'Sree Karthikeya', Sithalapakkam
- ❧ Poomalai 'Sree Aathi lakshmi', Thiruvanmiyur
- ❧ Poomalai 'Sree Nathan', Thoraipakkam, OMR
- ❧ Poomalai 'Sree Shanmuga Nillayam', Palavakkam
- ❧ Poomalai 'Sree Thirumurugan', Palavakkam
- ❧ Poomalai 'Sree Senthil velavan', Rajakilpakkam
- ❧ Poomalai 'Sree Shenpagam', Thoraipakkam
- ❧ Poomalai 'Sree Swamynathan', Shankar Nagar, Chrompet
- ❧ Poomalai 'Sree Senthur Nilayam', Thiruvanmiyur
- ❧ Poomalai 'Sree Skantha Nilayam', Baby Nagar, Velachery
- ❧ Poomalai 'Sree Thanigai Nilayam', Sholinganallur
- ❧ Poomalai 'Blossom', Annanagar, Velachery
- ❧ Poomalai 'Mukesh', Palavakkam
- ❧ Poomalai 'Guru Nivas', Velachery
- ❧ Poomalai 'Sree Thaimookambikai', Thiruvanmiyur
- ❧ Poomalai 'Sree Sarojan', Thiruvanmiyur

- ❧ Poomalai 'Pannai Pearls', Adyar
- ❧ Poomalai 'Mani Vilas', Vannandurai
- ❧ Poomalai 'Poonam', Madipakkam
- ❧ Poomalai 'Lakshmi Pearls', Palavakkam
- ❧ Poomalai 'Mansarovar, Palavakkam
- ❧ Poomalai 'Dhanyaa', Thiruvanmiyur
- ❧ Poomalai 'Santosh Pearls', Palavakkam
- ❧ Poomalai 'Daksha', Adyar
- ❧ Poomalai 'Lakshita', Selaiyur
- ❧ Poomalai 'Sreeya', Thoraipakkam
- ❧ Poomalai 'Hiranya', Kandanchavadi
- ❧ Poomalai 'Naveen's', Irumbuliyur
- ❧ Poomalai 'Aksharaa', Perungudi
- ❧ Poomalai 'Ruchika', Thiruvanmiyur

On-going Projects:

- ❧ Poomalai 'Gopinath Blossom', Palavakkam
- ❧ Poomalai 'Varishta', Medavakkam
- ❧ Poomalai 'Dhara', Thiruvanmiyur
- ❧ Poomalai 'The Wind', Kolapakkam
- ❧ Poomalai 'Aksharaa - 2', Perungudi
- ❧ Poomalai 'Avantikaa', Thiruneermalai, Chrompet
- ❧ Poomalai 'SaiPearls', Madipakkam
- ❧ Poomalai 'Krishnaashree', Palavakkam, ECR
- ❧ Poomalai 'The Wave', Neelankarai, ECR
- ❧ Poomalai 'Vistaa', Palavakkam, ECR

Up Coming Projects:

- ❧ Poomalai 'Yasika', Varadharaja Puram (Tambaram)
- ❧ Poomalai @ RK Shanmugam Salai, KK Nagar



For Bookings Contact:

+91 81 8989 2222

Email: sales@poomalaihousing.com

Visit www.poomalaihousing.com



POOMALAI
The Wind
KOLAPAKKAM, PORUR

For Booking Contact:

+91 81 8989 2222

Site Address:

No.1, 116/2A, BT Nagar, Kolapakkam (Porur)
Chennai- 600 122.

Member of
CREDAI
Chennai



POOMALAI
HOUSING PRIVATE LIMITED
your dreams are built here

Vel's Poomalai,

Plot No. 409 A, Door # 7,

6th East Street, Kamaraj Nagar,

Thiruvanmiyur, Chennai - 600 041

Email: sales@poomalaihousing.com

www.poomalaihousing.com

Disclaimer: The visual directions in this Brochure are for indicative purpose only. The plans and areas as mentioned in the Brochure are subject to change. This depictions in this Brochure are not legally binding on the developer or its agents. The final agreement between the customer and developer is the only legally binding document.